



Nuova Rade

Marine - Plastics Technology Experts

Instruction Manual

Diverter Valve, 3-way for tanks

196791

Diverter Valve, 3-way for tanks

The Nuova Rade **3-way Diverter Valve for tanks** is a universal valve that can be used installed on boards or on bilge evacuation systems. It allows the operator to choose between two outlets.

Features:

- Corrosion resistant ABS and stainless steel structure.
- Ideal for marine sewage and bilge pumpout systems.
- Ports: 1-1/2" ID flexible hose
- Can be padlocked.
- Long distance control by means of a push-pull cable.

Indicative Uses

The 3-way valve is ideal to be mounted on marine sewage treatment plants installed onboard, as well as on bilge evacuation systems.

Bilge Systems:

For boats having two separate bilge areas, the y-valve allows to empty either one, with only one pump. By simply selecting the appropriate valve selector lever, either of the two bilges can be evacuated.

Sewerage Systems:

When installed in the holding tank discharge line, the y-valve allows the choice between pump out through a deck fitting or directly through a seacock. When installed in the marine toilet discharge line, it allows the choice between storing the effluent in the waste tank or discharging it directly overboard (if legal).

Effluent must always be discharged in accordance with the local regulations.

Installation

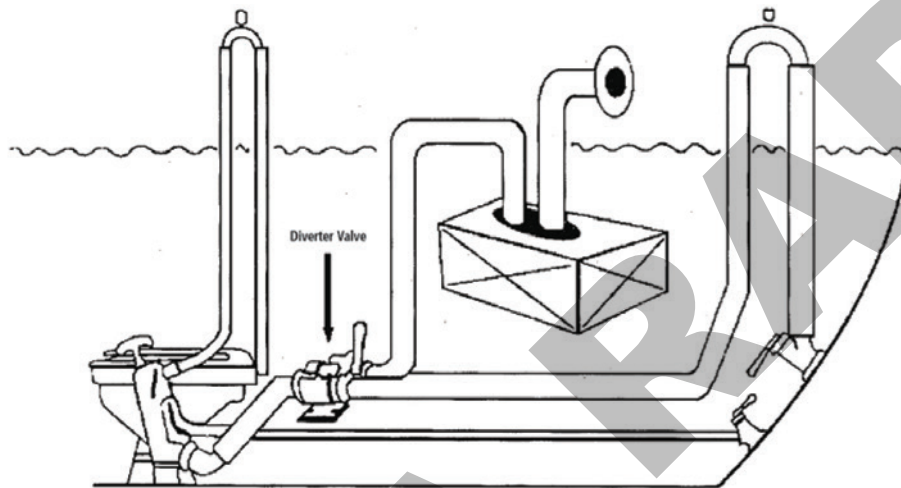

Picture 1 Mounting scheme

Choosing the appropriate location:

- Choose the appropriate location to install the 3-way valve, so that sharp bends, kinks or loops trapping water are eliminated.
- The mounting location should be as flat as possible; mounting on uneven surfaces might cause damage to the 3-way valve.
- After a convenient and accessible place has been determined, make sure that there is adequate room for the selector lever to be toggled.

Mounting:

- Mark locations for the mounting screw holes.
- Connect the inlet and outlet hoses to the corresponding ports and fasten them with stainless steel band clamps. It is recommended that all hoses employed in waste systems are of the heavy, non-collapsible, fabric reinforced type. Vacuum cleaner type hoses or vinyl hoses might collapse under the vacuum of a dockside pumpout system, or allow sewage gas to leak into the boat.

Upkeep

If the 3-way valve gets damaged or clogged with debris during service, it will be necessary to disassemble the unit.

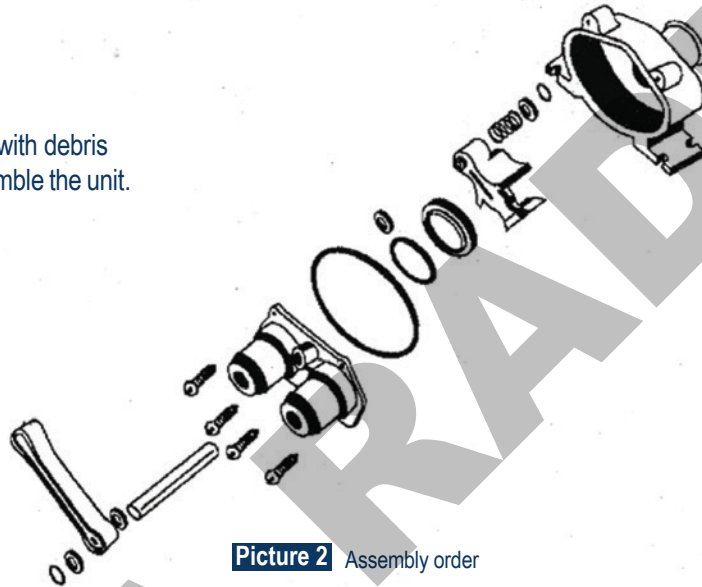

Picture 2 Assembly order

Before disassembly:

- Empty all hoses and the valve of waste liquids and thoroughly flush the whole system with clean water. Rinse the system again with a water and bactericide mixture and flush with more clean water.
- Remove all hoses from the valve and move it to an area where it can be conveniently disassembled.

Disassembly - Cleaning:

- Remove the four screws from the face plate.
- Remove face-plate and shaft/handle assembly from the body.
- Remove all debris from valve and inspect for damaged components. In case any part of the shaft/handle unit or of the port seal should need to be replaced, it will be necessary to disassemble the shaft/handle unit.
- **Do not remove the retaining ring at the spring end of the shaft.**
- Slide handle and washers off the shaft and slide shaft and swivel block out of the bore in the face plate.
- Replace all damaged parts and re-assemble all components on the shaft. The spring must be compressed to allow the retainer ring to snap into the slot on the shaft.

After cleaning:

- Re-assemble the 3-way valve and install it again in the waste system.
- **Carefully check the system for leaks.**